

Pensacola Beach Gulf Snorkeling Reef

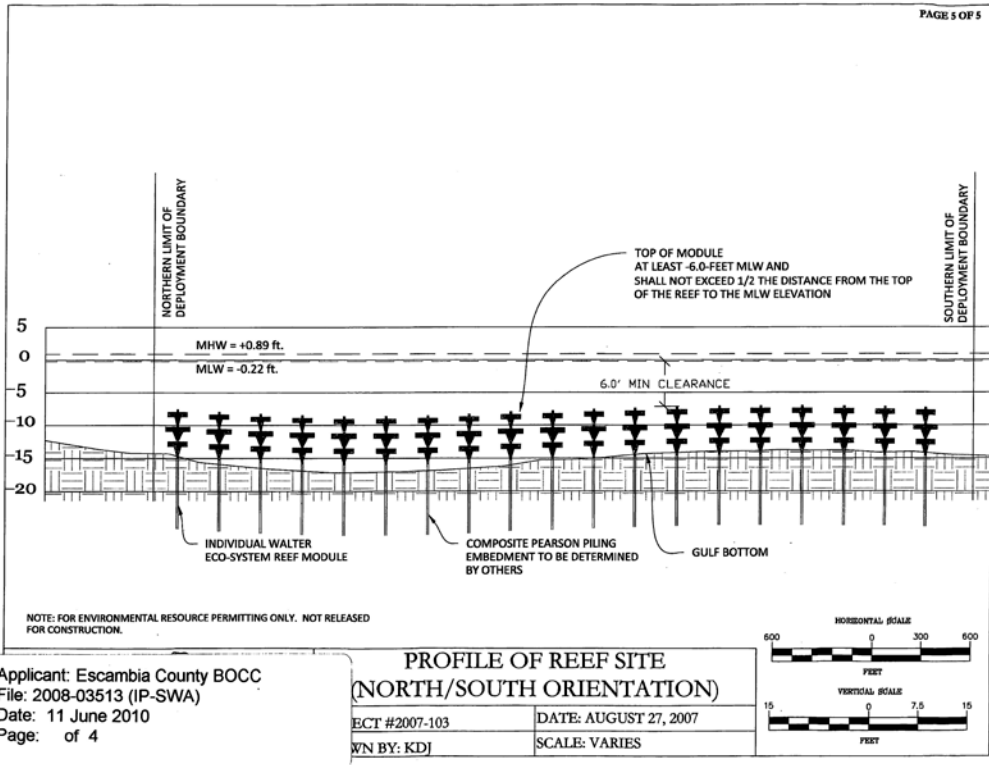



Applicant: Escambia County BOCC
 File: 2008-03513 (IP-SWA)
 Date: 11 June 2010
 Page: of 4

**PROFILE OF REEF SITE
 (NORTH/SOUTH ORIENTATION)**

PROJECT #2007-103	DATE: AUGUST 27, 2007
DRAWN BY: KDJ	SCALE: VARIES

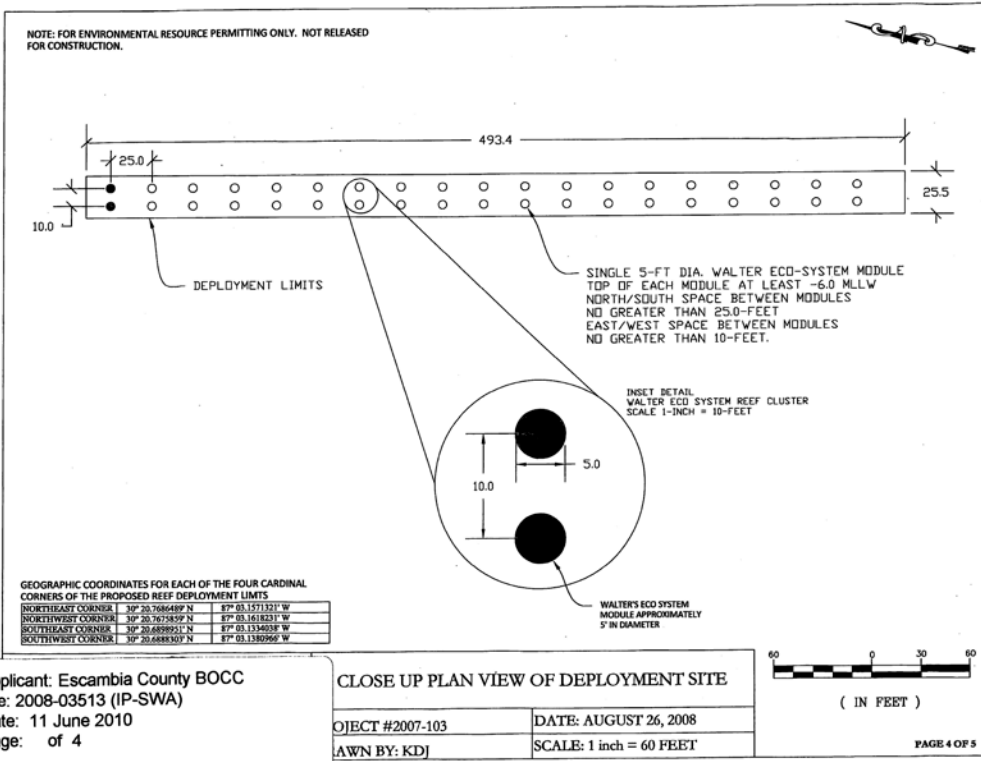

Applicant: Escambia County BOCC
 File: 2008-03513 (IP-SWA)
 Date: 11 June 2010
 Page: of 4

CLOSE UP PLAN VIEW OF DEPLOYMENT SITE

PROJECT #2007-103	DATE: AUGUST 26, 2008
DRAWN BY: KDJ	SCALE: 1 inch = 60 FEET

To assist locating the Gulf Snorkeling Reefs, Escambia County has installed Range Markers.



To find reefs, line up Range Markers and swim offshore approximately 450 feet to a water depth of 14 feet. Top of reefs are approximately 9 feet below water surface.

